



Product Manual

**EcoLiner™ SP
Self-Propelled Field Striping Machine
Honda Engine**

10005122



Proudly Made in the USA
Newstripe.com • 303-364-7786

EcoLiner™ SP Self-Propelled Field Striping Machine (Honda Engine)

TABLE OF CONTENTS

| | |
|---|----------|
| Precautionary Warning | Page 1 |
| Assembly | Page 2 |
| Operation | Page 3 |
| Cleaning Procedure..... | Page 4 |
| Cleaning Procedure..... (Winter Storage) | Page 4 |
| Maintenance..... | Page 4 |
| Spray Gun Assembly | Page 5 |
| Parts List | Page 6 |
| Troubleshooting Guide | Page 8-9 |
| Warranty..... | Page 10 |

Thank you for purchasing the Newstripe EcoLiner™ SP Self-Propelled Field Striping Machine.

Please read over the instructions and make sure you understand the operating procedures before using the unit.

Please check the serial number on your unit. This Manual is for units with a Honda Engine and serial number 1025474 and above only. For units with serial numbers below 1025474, please contact Newstripe for the correct product manual.



EcoLiner™ SP Self-Propelled Field Striping Machine (Honda Engine)



PRECAUTIONARY WARNINGS

- **PLEASE** read and understand all operation instructions as detailed in this manual. Failure to follow specified instructions may result in equipment damage or severe injury to personnel.
- **DO NOT** use latex paints from hardware stores or home improvement centers in your machine. These types of paints have binders in them that will adhere to the internal parts of the pump, causing damage. You will not be able to clean these substances from the pump. You must use a good quality true water-based athletic field striping paint in your machine.
- **DO NOT** use solvent based paints in this machine. Use only good quality true water-based athletic field striping paint.
NOTE: Damage caused by use of the wrong paint is NOT COVERED UNDER WARRANTY!
- **ALWAYS** thin the paint in accordance with the manufacturer's recommendations prior to use. Most field-marking paints must be thinned before use with the EcoLiner. These paints are typically thinned at a minimum ratio of 1:1.
- **DO NOT** use paint that has not been thinned, as it will clog your machine.
- **ALWAYS** strain the paint before use. Field marking paint often has oversized material, lumps, and debris. If not properly strained, these contaminants will be drawn into the hoses, pump, and spray nozzle or spray gun where they may restrict paint flow.
- **NEVER** perform maintenance on the machine while the system is under pressure.
- **DO NOT** use solvents to clean the system. Solvents will damage internal components. Use only warm soapy water.
- **ALWAYS** consult your Facility Safety and/or Personnel Department for specified safety protocols prior to operating this equipment.

EcoLiner™ SP Self-Propelled Field Striping Machine (Honda Engine)

Your EcoLiner SP Parts Box Should Include:

- Support arm for the spray gun with left & right spray shields
- Gun mount
- Spray gun assembly
- Nozzles 5002 for 2"-3" lines and 9005 for 5"-6" lines
- Pail paint strainer
- Product Manual

ASSEMBLY

1. The EcoLiner SP is shipped mostly assembled. You are only required to attach the spray gun assembly and paint hose.
2. Slide the support arm with the spray shields through the right side receiver tube on the front of the chassis, until the end of the support arm is flush with the left side of the receiver.
3. Tighten down the star knobs to secure the support arm.
4. Slide the gun mount with the spray gun, down onto the upright of the support arm with spray hose connection facing rearward.

NOTE: The line width is adjusted by raising or lowering the spray gun and also by selecting the appropriate spray nozzle.

5. Tighten the star knob to secure the gun mount.
6. Connect the paint hose from the pressure valve to the spray gun. Tighten the hose connection lightly with a wrench.
7. **CHECK THE ENGINE OIL.** This machine is shipped with Mobil 1 5W-30 Full Synthetic Motor Oil. The full level is between the cross hatched markings on the dipstick with the dipstick pushed against the fill port. (Not screwed in.)

Note: DO NOT OVERFILL THE ENGINE OIL.

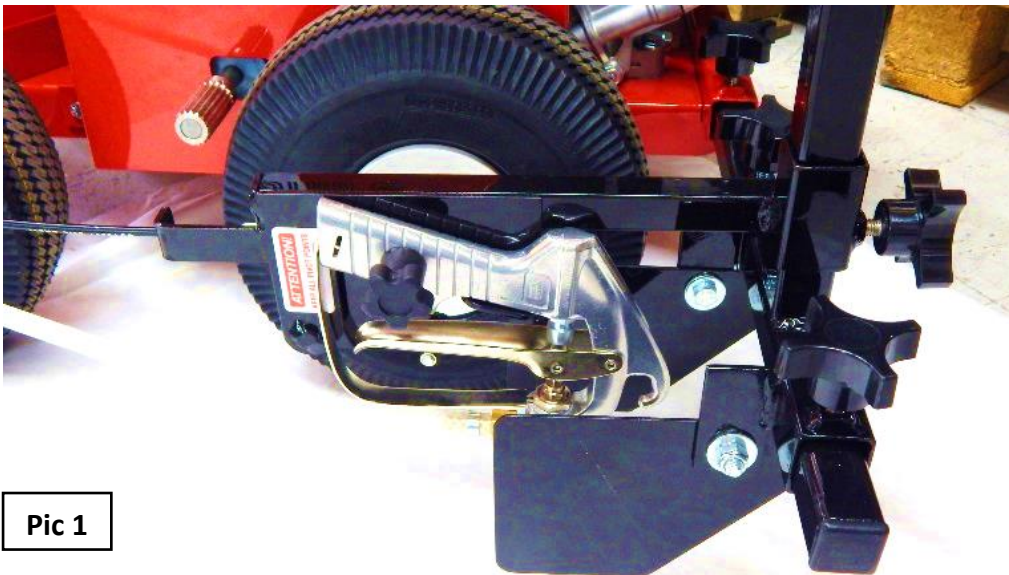

Pic 1

EcoLiner™ SP Self-Propelled Field Striping Machine (Honda Engine)

OPERATION

1. Adjust the spray shields to a 4" width. You may have to raise or lower the spray gun so that the machine will produce a 4" line. To stripe narrower or wider lines, select the proper spray nozzle from the application description table on page 5. Adjust the spray shields for the line width desired and then adjust the spray gun up or down as needed to produce the desired line width.
2. Move the pump engagement lever to the "OFF" position, toward the rear of the machine.
3. Disengage the self-propelled drive mechanism by pulling the lever back toward the rear of the machine.
4. Add water (for testing, practicing, or cleaning) or pre-thinned and strained paint to the pail.
5. On the engine, move the On/Off fuel lever to the "On" position. Move the choke lever to the "choke" position. Move the throttle lever to about the $\frac{3}{4}$ position. Turn the On/Off switch to the "On" position. Pull the starter cord. Once the engine begins to run, move the choke lever to the run position. Adjust the throttle slightly to where the engine runs the smoothest.
6. Move the pump engagement lever to the forward "ON" position. The lever should now be in a horizontal position.
7. Open the pump prime valve next to the pressure valve. Lift the lid slightly on the pail and watch the paint flow from the return hose. Once there is a continuous flow from the hose, close the pump prime valve. The unit should now spray when the lever on the handle is squeezed.
8. To engage the self-propelled mechanism, simply push the drive lever to the forward most position. Pull the drive lever back to stop. The speed is controlled by adjusting the engine speed.



OPERATIONAL NOTES

- **ADJUST** the side spray shields for line width and then adjust the spray gun height up or down as needed to achieve the desired line width.
- **NOTE:** water will produce a wider line than paint.
- **ALWAYS** thin the paint in accordance with the manufacturer's recommendations prior to use. Most field-marking paints must be thinned before use with the EcoLiner. These paints are typically thinned at a minimum ratio of 1:1.
- **ALWAYS** strain the paint before use. Field marking paint often has oversized material, lumps, and debris. If not properly strained, these contaminants will be drawn into the hoses, pump, and spray nozzle or spray gun where they may restrict paint flow.
- **ALWAYS** prime the pump before each use and when you run the pail dry. If you need to reduce the spray pressure, unscrew the pressure valve cap until it is where you would like it, and then run the locking ring up against the cap to maintain the pressure setting.
- **ALWAYS** disengage the pump lever when the paint pail becomes empty. Continuing to run the pump when paint has run out will dry paint inside the pump.

EcoLiner™ SP Self-Propelled Field Striping Machine (Honda Engine)

CLEANING PROCEDURE

1. When your striping job is complete, pull the paint return hose & prime valve hose out of the lid and point them toward the ground behind the machine or into a separate pail.
2. Remove the paint pail lid, wipe it off, and set it aside. Pull out the suction hose and wipe or rinse it off, and then place it in a clean container of water.
3. Remove the nozzle cap, nozzle, and valve seat from the gun and put them in a container of soapy water to soak.
4. Remove the pail of unused paint from the machine and cover it for use the next time you stripe.
5. Place an empty pail on the machine and add two gallons of clean soapy water. Place the suction hose in the pail on the machine but leave the return and pump prime hoses out of the pail. This allows you to flush all of the hoses of paint.
6. Clean the spray gun parts that have been soaking and then reassemble them onto the spray gun.
NOTE: The cone shaped depression in the gun seat goes toward the spray nozzle.
7. Start the engine and then use the pump prime valve to prime the pump. Activate the spray gun until the spray runs clear with water.
CAUTION: The return hoses will “jump” from the fluid pressure when cycling the prime valve.
8. Clean and rinse the exterior of the machine with warm soapy water. **Pressure washing is not recommended.**
9. Use soapy water at least once a week to thoroughly clean the pump. Add soap (dish washing detergent) to 2-3 gallons of water, and then run the machine and let it circulate back to the pail as long as desired. Once you have completed this, empty the pail.

CLEANING PROCEDURE FOR WINTER (FREEZING) STORAGE

1. Clean as instructed in the normal cleaning procedure.
2. Remove as much gas from the engine fuel tank as you can. Run the engine until it runs out of gas.
3. Disconnect the paint hoses from the pump and gun and then drain the hoses.
4. Remove the screen from the suction hose and hold the end up. Pour a little Newstripe Pump Defender into the hose. Pull the cord on the engine to draw the Pump Defender into the pump. The unit may now be stored in freezing temperatures.
5. Drain and change the engine oil in the spring before adding fuel to the tank for the first use.

MAINTENANCE

| ITEM | CHECK | MAINTENANCE ACTION |
|--|---|--|
| Engine Oil Full Synthetic SAE 5W-30 | Prior to every use | Change the engine oil after the first 20 hours of operation and then every 100 hours thereafter. |
| Paint System | After every use | Clean the paint pail, hoses, and gun. |
| Hoses and Pump | After every use | Run soapy water through the pump and hoses for additional cleaning. |
| Wheels and Tires | Check the air pressure before each use. | Fill the tires with air as needed. Grease the wheels monthly. |
| Handles | Monthly | Check the handle bolts for tightness to the chassis and handle braces. |
| Engine Air Filter | Monthly | Replace every 4 months |

EcoLiner™ SP Self-Propelled Field Striping Machine (Honda Engine)

SPRAY GUN ASSEMBLY (10001949)

| Item | Description | Part Number |
|------|------------------------|-------------|
| #43 | Low Pressure Spray Gun | 10000147 |
| #44 | Valve Seat | 10000136 |
| #45 | 8004 Nozzle Included | N/A |
| #46 | Nozzle Cap (4-Pack) | 10001890 |

| Nozzle (4-Pack) | Application Description | Part Number |
|-----------------|----------------------------|-------------|
| 5002 | 2" - 3" Lines | 10001891 |
| 8002 | 4" - 5" Lines (Short Turf) | 10001892 |
| 8004 | 4" - 5" Lines | 10001893 |
| 8005 | 4" - 5" Lines (Heavy Turf) | 10003493 |
| 9505 | 5" - 6" Lines | 10001894 |

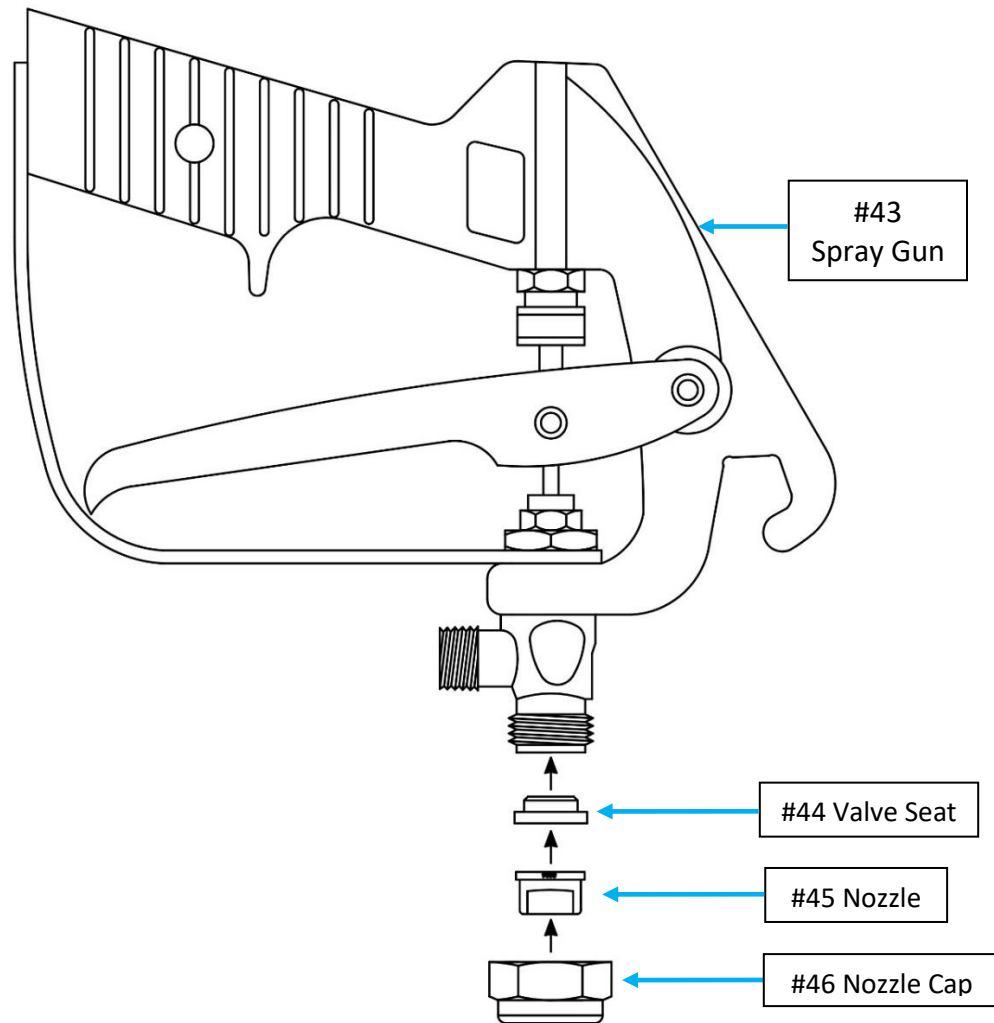

ENGINE LUBRICANT AND PARTS

| ITEM | SPECIFICATIONS |
|--------------|--|
| Engine | Part Number 10000371, Honda GX120 With Oil Alert |
| Oil Capacity | 18 Ounces (0.56 Liters) Full Synthetic 5W-30 |
| Spark Plug | NGK Part Number BPR6ES or Denso Part Number W20EPR-U |
| Air Filter | Part Number 10000401 |

EcoLiner™ SP Self-Propelled Field Striping Machine (Honda Engine)

PARTS LIST

| Item | Description | Part Number | Item | Description | Part Number |
|------|--|-------------|------|---------------------------------------|-------------|
| 1 | Chassis | 10004610 | 28 | Hose Assembly, Pump Pressure | 10004469 |
| 2 | Engine, Honda GX120 | 10000371 | 29 | ½" Male Brass Tee Fitting | 10004111 |
| 3 | Engine Air Filter Element (Not Shown) | 10000401 | 30 | ½" to ¼" Brass Reducer Fitting | 10002481 |
| 4 | Wheel Assembly (4) | 10000012 | 31 | Pump Prime Valve | 10000233 |
| 5 | Handles | 10003469 | 32 | ¼" Brass 90 Deg. Male Elbow Fitting | 10000159 |
| 6 | Handle Support Braces (2) | 10004612 | 33 | ¼" Female Brass Cross Fitting | 10000235 |
| 7 | Control Cable | 10002518 | 34 | ¼" Brass 90 Deg. Street Elbow Fitting | 10004131 |
| 8 | Control Lever | 10002951 | 35 | ¼" Brass Plug Fitting | 10000113 |
| 9 | Throttle Cable | 10000696 | 36 | ¼" Brass Ball Seat Hex Nipple Fitting | 10000731 |
| 10 | Drive Lever | 10002072 | 37 | Pump Engage Lever | 10001817 |
| 11 | Drive Control Rod | 10002087 | 38 | Belt Guard | 10002030 |
| 12 | Hose Assembly, Paint | 10000695 | 39 | 3/8" MPT x MGHT 90 Deg. Fitting | 10004459 |
| 13 | Hose Assembly, Suction | 10004470 | 40 | Pump Assembly | 10003367 |
| 14 | Filter Screen, Suction Hose (Not Shown) | 10002842 | 41 | Drive Assembly | 10002088 |
| 15 | Hose Assembly, Return (2) | 10003692 | 42 | Drive Rollers (2) | 10003387 |
| 16 | Spray Gun Mount | 10004651 | 43 | Gun Mount Star Knob | 10004480 |
| 17 | Spray Gun Assembly | 10001949 | 44 | Belt, Drive (A26) | 10001757 |
| 18 | Spray Gun Support Arm | 10003550 | 45 | Belt, Pump Drive (3L260) | 10001755 |
| 19 | Pivot Assembly with Shield, Right | 10004825 | 46 | Pulley, Pump Belt Idler | 10001111 |
| 20 | Pivot Assembly with Shield, Left | 10004824 | 47 | Pulley, Drive Belt Idler | 10001111 |
| 21 | Star Knob, Common (5) | 10000007 | 48 | Pulley, Drive | 10001115 |
| 22 | Cable Adjuster with Nut | 10000018 | 49 | Pulley, Engine | 10001739 |
| 23 | Cable Swivel Stop | 10001577 | 50 | Pulley, Pump (Not Shown) | 10003368 |
| 24 | Pressure Valve Adjusting Cap (Part Of Valve) | N/A | 51 | Spring, Pump Belt Tensioner | 10000649 |
| 25 | Locking Ring (Part Of Valve) | N/A | 52 | Spring, Idler Arm | 10000692 |
| 26 | Pressure Limiter Collar (Part Of Valve) | N/A | 53 | Bearing, Pump Shaft (2) | 10003131 |
| 27 | Pressure Valve | 10003478 | 54 | Pump Shaft | 10003365 |

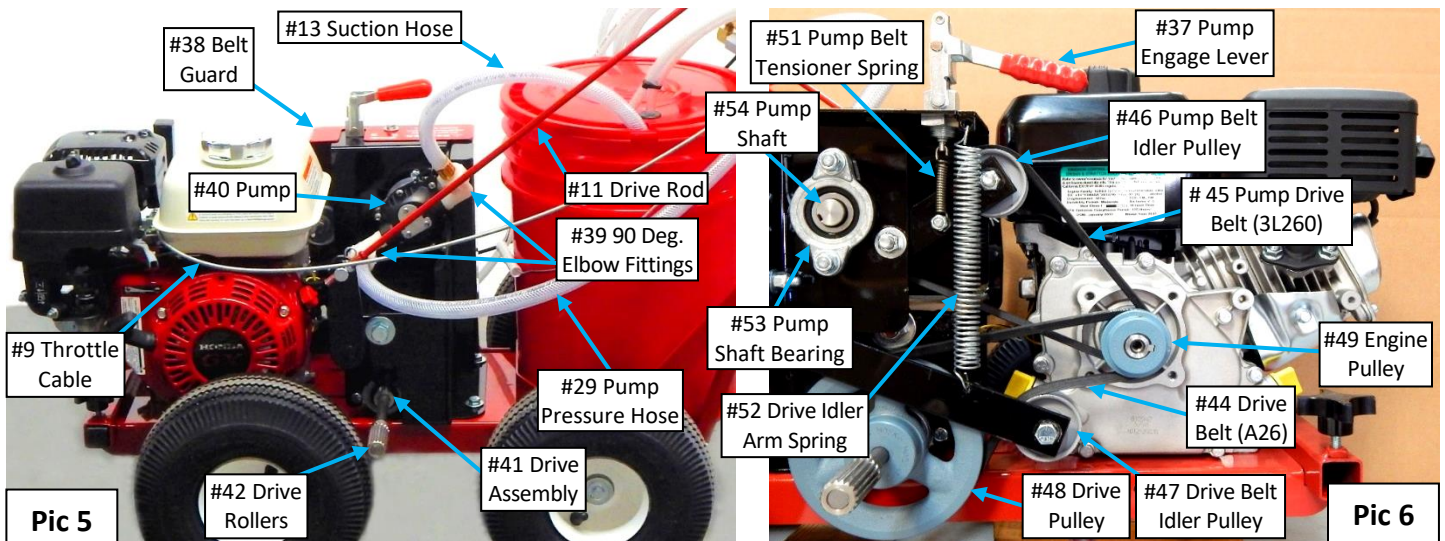

EcoLiner™ SP Self-Propelled Field Striping Machine (Honda Engine)

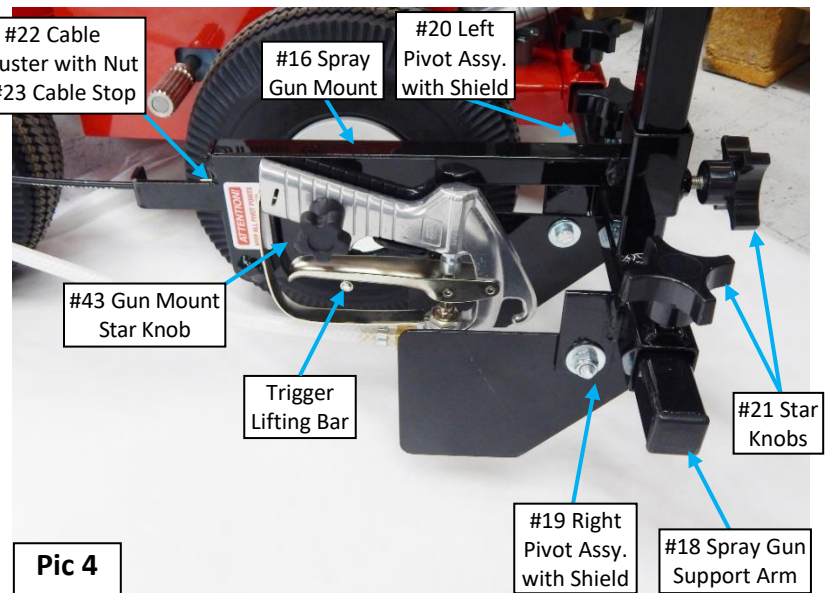
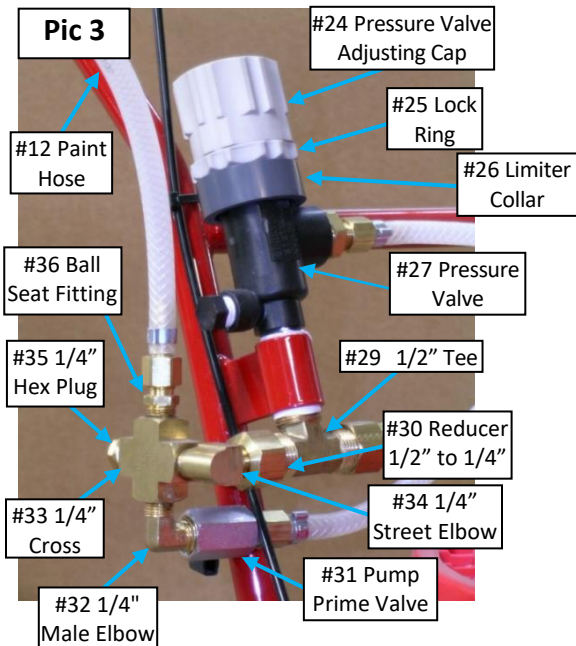
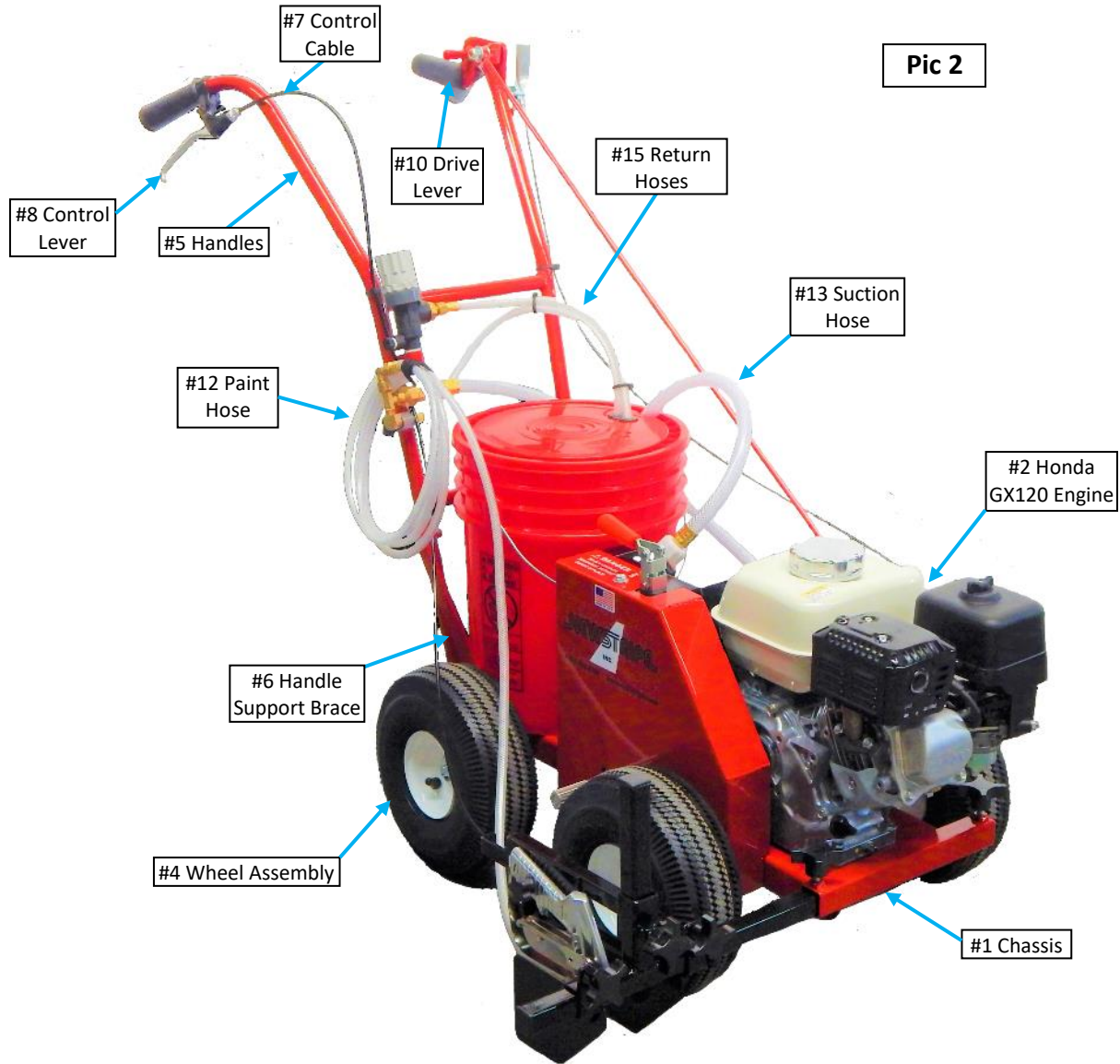

EcoLiner™ SP Self-Propelled Field Striping Machine (Honda Engine)

TROUBLESHOOTING GUIDE

| PROBLEM | POSSIBLE CAUSE | REMEDY |
|---|---|--|
| The pump will not prime. | There is air in the spray system. | Open the pump prime valve and check for flow from the return hose into pail. When the flow is continuous, close the valve. |
| The pump will not prime after relieving the air in the system. | The pump or hoses may be restricted. | Disconnect the supply and discharge hoses and clean them. Pour hot soapy water into the inlet of the pump and let it soak. Reconnect the hoses and restart the pump. |
| The pump still will not prime. | The spray system was not thoroughly cleaned after the previous use. | Pour more hot soapy water into the inlet of the pump. Jog the pump by pulling the starter cord several times with engine off to get the soap into the pump. Let it soak 15-30 minutes, and then try pumping water. If the pump starts pumping water, let it circulate the water for 5-10 minutes before adding paint. The pump does not need to be rinsed of the soap, as it will mix easily with the paint. If the pump still will not prime, call Newstripe for assistance. Disassembly of the pump will void the warranty. |
| The pump will not run. | The drive belt is loose or broken. | Inspect, and then adjust or replace the belt. The belt should deflect approximately ½" between pulleys. |
| The paint is leaving the nozzle in a stream, and not a spray pattern. | The paint is too thick | Thin the paint. |
| The pressure too low. | The pressure valve needs adjusted. | Loosen the locking ring. Turn the pressure valve cap clockwise to increase the pressure and then run the locking ring up against the cap to maintain the pressure setting. Do not remove the locking ring. |
| The spray stream is inconsistent. | The nozzle screen is obstructed. The suction hose screen is clogged or obstructed. | Remove the nozzle screen and clean or replace it. Remove suction hose and screen. Filter the paint, clean the screen, and remove any clogs. |
| The spray pattern is too narrow or is uneven. | The spray gun height is incorrect. The nozzle may be the wrong size, or misaligned. The paint viscosity may be too thick. | Adjust the spray gun height up or down to achieve the desired line width. See the Nozzle Assembly Guide. The nozzle slot must be at 90 degrees to the direction of travel. Thin the paint in accordance with the manufacturer's recommendations. |

EcoLiner™ SP Self-Propelled Field Striping Machine (Honda Engine)

TROUBLESHOOTING GUIDE CONTINUED

| PROBLEM | POSSIBLE CAUSE | REMEDY |
|---|--|--|
| Paint drips from the gun nozzle after releasing the lever. | <p>The control cable is out of adjustment.</p> <p>The valve seat in the spray gun is dirty or worn.</p> <p>The gun is not in the mount correctly.</p> <p>Faulty control lever.</p> <p>The gun mount pivot points or the spray control lever needs lubrication.</p> | <p>Check the cable at the spray gun mount. Adjust the cable as needed or replace it if it is damaged.</p> <p>Disassemble the gun and clean or replace the valve seat.</p> <p>Adjust the gun position so that the trigger lifting bar allows spray trigger to release completely.</p> <p>Replace the lever if it is worn or damaged.</p> <p>Keep all gun mount pivot points, the spray control lever, and pump engage lever lubricated with spray oil containing PTFE, such as Slick 50 One Lube.</p> |
| The drive rollers are turning but the unit will not move when the drive is engaged. | <p>The drive control rod is out of adjustment.</p> | <p>Remove the hairpin clip that holds the adjustment nut in the drive unit arm. Loosen the adjustment nut jam nut. Turn the adjustment nut clockwise a couple turns, and then reassemble it in the drive unit arm in reverse order. Make sure that both tires are inflated equally for proper engagement.</p> |
| The drive rollers are not turning. | <p>The drive belt or the drive belt tensioner spring may be broken.</p> | <p>Replace the drive belt or the drive belt tensioner spring as needed.</p> |

Your machine is designed to be simple and safe to operate.

Please call Newstripe at 303-364-7786 if you have any questions during setup, painting or cleaning.

EcoLiner™ SP Self-Propelled Field Striping Machine (Honda Engine)

10005122

24 Month Warranty

Newstripe, Inc. ("Newstripe") warrants to the original purchaser, for 24 (Twenty Four) Months after date of purchase, that the equipment* hereby sold shall be free of defects in materials and workmanship. This warranty does not extend to any damage or malfunction resulting in misuse, neglect, accident, improper operation, or normal wear and tear.

* Gasoline engines, compressors, low pressure pumps, and transaxles are furnished with their respective manufacturers' warranties only and are not covered by any warranty of Newstripe. High pressure pumps manufactured by Newstripe (excluding wear items like diaphragms and valves) are warranted for materials and workmanship for 12 Months after the date of purchase.

Damage incurred in shipment from Newstripe to the purchaser is the total responsibility of the shipping carrier. The purchaser is responsible for noting any damages on the Bill of Lading of the shipping carrier and Newstripe will work with the shipping carrier to resolve any damages incurred.

The Newstripe obligation under this warranty and any implied warranties is limited to replacement or repair of defective parts of its manufacture without charge for 24 (Twenty Four) Months from date of purchase. For service under this warranty, the purchaser shall obtain an approved Return Materials Authorization (RMA) from Newstripe and then ship the defective part or parts of the equipment, transportation prepaid by the purchaser, to Newstripe together with a written description of any claimed defect and proof of purchase date of the materials being returned. To review Newstripe's complete guidelines for warranty claims and returns, please visit our website at www.newstripe.com.

The responsibilities described above are the only responsibilities of Newstripe under this written warranty or any implied warranty and may be exercised only within 24 (Twenty Four) Months from the date of original purchase. In no event shall Newstripe be liable for incidental or consequential damages and no person had any authority to bind it to any representation or warranty. Newstripe is not responsible for work done, materials furnished, or repairs made by others without its specific written authorization.

This warranty shall be in lieu of any and all other warranties, expressed or implied, including any warranties of merchantability or fitness for a particular purpose, and there is no other representation or warranty of any kind with respect to the goods sold hereby except as set forth herein. It is expressly agreed that this warranty shall be limited to the adjustment, repair or replacement of parts and the labor and services required thereby. In no event, including any claim of negligence, shall Newstripe be liable for incidental or consequential damages.



Newstripe.com / 303-364-7786