

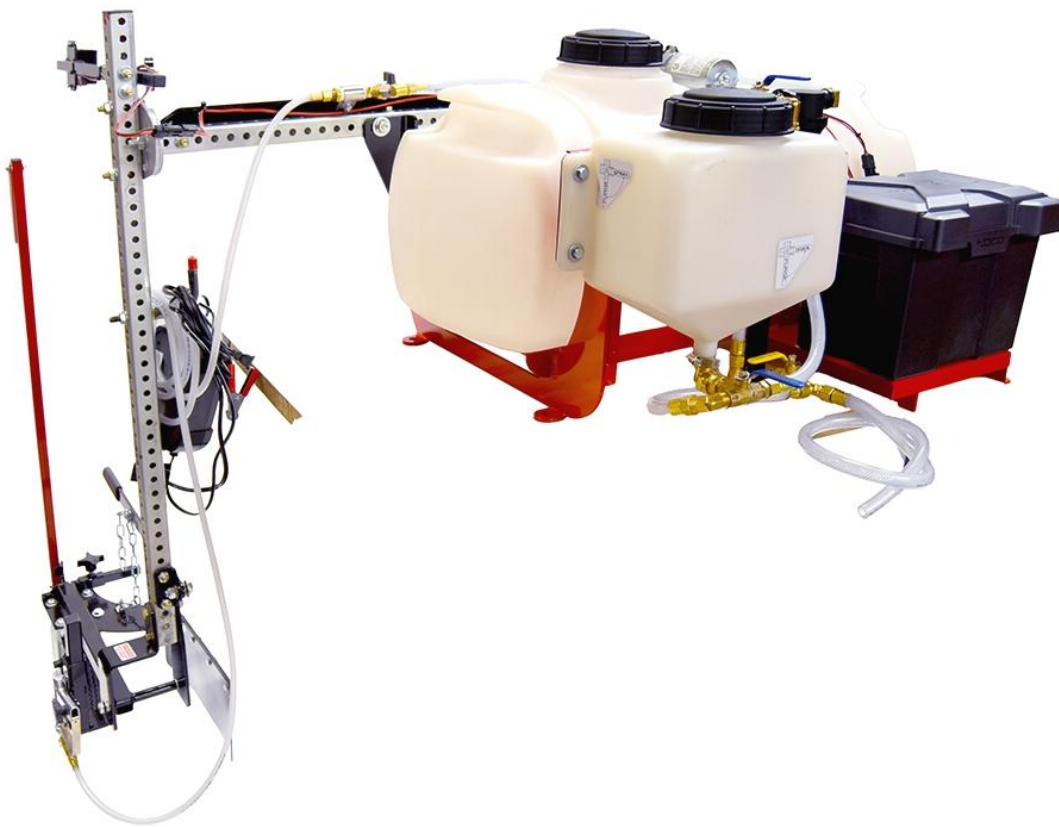

Product Manual

LineRider™ Electric UTV Mounted Line Striper

10005241



Proudly Made in the USA
Newstripe.com • 303-364-7786

LineRider™ Electric UTV Mounted Line Striper

TABLE OF CONTENTS

Precautionary Warnings	Page 1
Assembly	Page 2-3
Operation	Page 4
Recharging the Battery	Page 4
Maintenance	Page 4
Cleaning Procedure	Page 5
Spray Gun Detail.....	Page 5
Parts List.....	Page 6
Troubleshooting	Page 7
Warranty	Page 8

Thank you for purchasing the Newstripe LineRider™ Electric UTV Mounted Line Striper.

Please read over the instructions and make sure you understand the operating procedures before using the unit.

Please check the serial number on your unit. This Manual is for units with serial number 1040562 and above only. For units with serial numbers below 1040562, please contact Newstripe for the correct product manual.



LineRider™ Electric UTV Mounted Line Striper



PRECAUTIONARY WARNINGS

- **PLEASE** read and understand all operation instructions as detailed in this manual. Failure to follow specified instructions may result in equipment damage or potential injury to personnel.
- **DO NOT** use latex paints from hardware stores or home improvement centers in your machine. These types of paints have binders in them that will adhere to the internal parts of the pump, causing damage. You should only use good quality true water-based athletic field striping paint in your machine.
- **DO NOT** use solvent based paints in this machine. Damage caused by use of the wrong paint is not covered under warranty.
- **ALWAYS** thin the paint in accordance with the manufacturer's recommendations prior to use. Most field-marking paints must be thinned before use with the LineRider Electric. These paints are typically thinned at a minimum ratio of 1:1.
- **DO NOT** use paint that has not been thinned, as it may clog your machine.
- **ALWAYS** strain the paint before use. Field marking paint often has oversized material, lumps, and debris. If not properly strained, these contaminants can be drawn into the hoses, pump, and spray nozzle or spray gun where they may restrict paint flow.
- **NEVER** perform maintenance on the machine while the system is under pressure.
- **DO NOT** use solvents to clean the system. Solvents will damage internal components. Use only warm soapy water.
- **ALWAYS** consult your Facility Safety and/or Personnel Department for specified safety protocols prior to operating this equipment.

LineRider™ Electric UTV Mounted Line Striper

ASSEMBLY

Required Items and Tools

- 12 Volt Group 24 Deep Cycle Battery (Not Included).
- Various Combination Wrenches, Sockets, or Adjustable Wrenches.

1. Check for any damage that may have occurred during shipment. Advise Newstripe immediately if you see any damage. Remove all shipping cartons from the pallet.
2. Remove the unit from the pallet and then place it in the bed of the vehicle it is to be used with. Make sure it is positioned square and as close to the front and left bed side of the vehicle as possible.
3. Anchor the unit to the bed of the vehicle with the provided tie down straps. For a stronger or more permanent anchoring, you may mark and drill the bed of the vehicle to anchor the unit, using the tabs on the LineRider chassis.
4. Install the vertical boom rail on the breakaway plate with two 7/16" x 2-1/2" bolts, and two 7/16" flanged lock nuts.

Note: Use the set of holes in the vertical boom that allows the spray head to ride as level as possible.

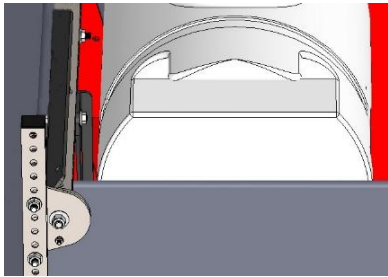

5. The spray gun will be in the gun mount when you receive the machine. Please make note of how it is positioned. Loosen the star knob in the gun mount and then slide it down onto the upright of the spray head. Pre-position the gun mount with the tube at about three inches up from the bottom of the upright and secure it with the star knob.

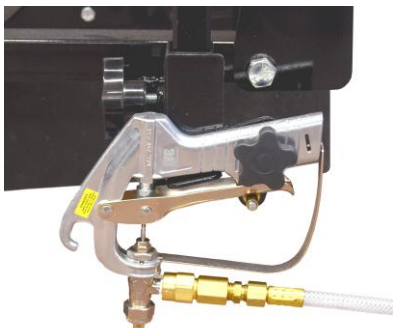

6. Coil the excess hose and place it on the hanger on the vertical boom and then connect the spray hose to the open port of the coupling on the horizontal boom.



7. Install the pointer in the front of the spray head from the outside. Position the pointer so that the dangle marker will be at the inside of the painted line and then secure it with the star knob. For example, if you are painting a 4" line, the dangle marker should be 2" in from the center of the spray nozzle. Some fine tuning may be needed, so we recommend practicing with water to achieve the desired results before painting.

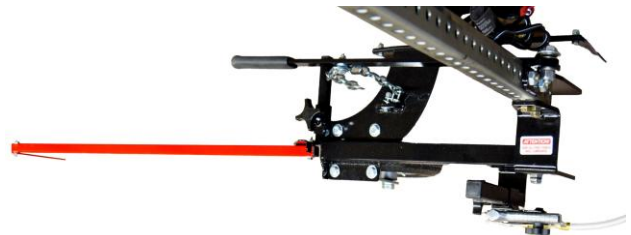

8. Remove the lid of the battery box and then place a Group 24 Deep Cycle Marine/RV 12 Volt Battery (not included) into the battery box with the terminals toward the unit. Connect the red wire of the battery harness to the Positive (+) terminal of the battery first and then connect the black wire of the battery harness to the Negative (-) terminal. After connections are made, snap the lid back onto the battery box.



LineRider™ Electric UTV Mounted Line Striper

ASSEMBLY CONTINUED

Note: The LineRider is designed to be used with the driver's door off the vehicle for viewing purposes during painting and for ease of entering and exiting the vehicle. You may still use it with the door on the vehicle, but these things may not be as easy. The receiver for the spray control switch comes pre-installed on the vertical rail. You may move it up or down on the rail for your comfort and suitability.

- Slide the spray control arm into the receiver to the desired position and secure it with the star knob as shown. Plug the switch wiring harness into the main wiring harness at the end of the horizontal rail.



OPERATION

- Always prime the LineRider prior to use. Make sure that the purge tank 3-way selector valve is in the "PURGE" Position. Fill the purge tank with water. Position the tank selector 3-way (top) valve to the "PURGE" Position.



Note: It is advisable to familiarize yourself with the equipment operation by using water the first time. The purge tank 3-Way valve should stay in the "PURGE" position unless you are draining the purge tank.

- Open the valve on the horizontal rail marked "OPEN TO PRIME PUMP" and then turn on the pump with the spray rocker switch on the control arm. Allow 15-30 seconds for the pump to prime. As soon as fluid begins to flow into the main tank, turn off the pump and close the valve. Check for leaks and tighten any fittings as required during this process.
- Position the tank selector 3-way (top) valve to the "SPRAY" Position before painting.

NOTE: The center position of the switch is off, the bottom position is momentary on, and the top position is continuous on.

- The LineRider is shipped with a nozzle installed for spraying a 4" wide line. Raising or lowering the spray gun will increase or decrease the line width.
- Remove the lid on the 25 gallon tank and place the included NoSpill in the fill port. Pour the desired amount of properly thinned and strained field paint into the tank. Before painting, hold the nozzle of the spray gun over the tank opening and press the spray rocker switch until paint flows from the nozzle. This will purge the paint spray hose and gun.

NOTE: These paints are typically thinned at a minimum ratio of 1:1. Follow the manufacturer's suggested paint thinning instructions.

- Position the spray nozzle where the painted line is to begin. Engage the spray rocker switch to the desired on position when ready to paint a line. An even flow of paint should spray from the nozzle. Use the line guide to aid in making straight lines.
- Place the spray rocker switch in the center (off) position when you would like the machine to stop spraying.
- To use the gun as a hand gun, remove the spray gun from the gun mount. Place the rocker switch in the forward (continuous on) position. After you are finished, place the rocker switch in the center (off) position and return the spray gun to the gun mount.

LineRider™ Electric UTV Mounted Line Striper

CLEANING PROCEDURE

1. When your striping job is complete, drain the paint from the LineRider into the desired container(s) by opening the bottom center valve at the back of the unit. Rinse the tank with water and properly discard the rinse water. Cover the container(s) of unused paint for use the next time you stripe.
2. Remove the nozzle cap, nozzle, and valve seat from the spray gun and put them in a container of water to soak.
3. Position the tank selector 3-way (top) valve to the "PURGE" Position.



4. Place the spray rocker switch in the top (continuous on position) to flush the water from the purge tank through the spray system and gun into a waste container until they are cleared of all paint. Use warm soapy water for heavier cleaning.
5. Clean the nozzle parts that have been soaking and reassemble them on spray gun.
6. Clean and rinse the exterior of machine with warm soapy water. **Pressure washing is not recommended.**

NOTE: Always leave some of the cleaning solution or Newstripe Pump Defender in the pump when not in use. This keeps the internal pump components lubricated. **DO NOT** run the pump without liquid. If you need to store the unit for extended periods or in freezing temperatures, run a solution of warm water and dishwashing detergent through the pump to clean out all paint. After flushing the system replace the soapy water solution with Newstripe Pump Defender (Part Number 10000459 sold separately) to protect the spray system from freezing.

RECHARGING THE BATTERY

NOTE: Before charging the battery, please read the Automatic Battery Charger Instructions.

1. Make sure the LineRider spray rocker switch is in the center "Off" position. All wiring may stay connected during battery charging.
WARNING: Connect and disconnect the battery charger clips **ONLY** when the battery charger is unplugged.
2. Connect the red positive (+) clip of the battery charger to the positive (+) terminal on the battery.
3. Connect the black negative (-) clip of the battery charger to the negative (-) terminal of the battery.
4. Plug the battery charger into any standard 110/120 volt AC outlet. If the battery is receiving power, the green power indicator should be illuminated.

5. Press the red "START STOP" button on the charger. If the battery is charging, the yellow/orange indicator on the battery charger should illuminate solid.
6. If the "CLAMPS REVERSED" indicator is illuminated, the charger connections are incorrect. If the "BAD BATTERY" indicator is illuminated, the battery is bad.
7. When the "CHARGED/MAINTAINING" indicator on the battery charger illuminates, the battery is fully charged, and the charger is in maintain mode.
8. Press the "START STOP" button to turn the battery charger off. Unplug the battery charger and then disconnect the battery in reverse order (negative clip first).

LineRider™ Electric UTV Mounted Line Striper

MAINTENANCE

ITEM	CHECK	MAINTENANCE ACTION
LineRider Unit	Before every use	Make sure the unit is properly secured in the vehicle.
Paint Tank, Hoses, and Nozzle	After every use	Clean the paint pail, hoses, and nozzle.
Pump, Hoses and Spray Gun	After every use	Run soapy water through the pump for additional cleaning.
Battery	After daily use Monthly	Charge with the included battery charger. Keep (wet cell only) batteries maintained to the full mark with distilled water.
Spray Head	Weekly	Lubricate all pivot points with light machine or spray oil.

SPRAY GUN ASSEMBLY (10002330)

Item	Description	Part Number
#1	Spray Gun Assembly (Complete)	10002330
#2	¼" Ball Seat Nipple	10000731
#3	Nozzle Body	10000028
#4	20 psi Nozzle Screen (4-Pack)	10002555
#5	Bushing	10002641
#7	Valve Seat	10000136
#8	8004 Nozzle Included	See Nozzles
#9	Nozzle Cap (4-Pack)	10001890

Nozzles (4-Pack)	Application Description	Part Number
5002	2" - 3" Lines	10001891
8002	4" - 5" Lines (Short Turf)	10001892
8004	4" - 5" Lines	10001893
8005	4" - 5" Lines (Heavy Turf)	10003493
9505	5" - 6" Lines	10001894

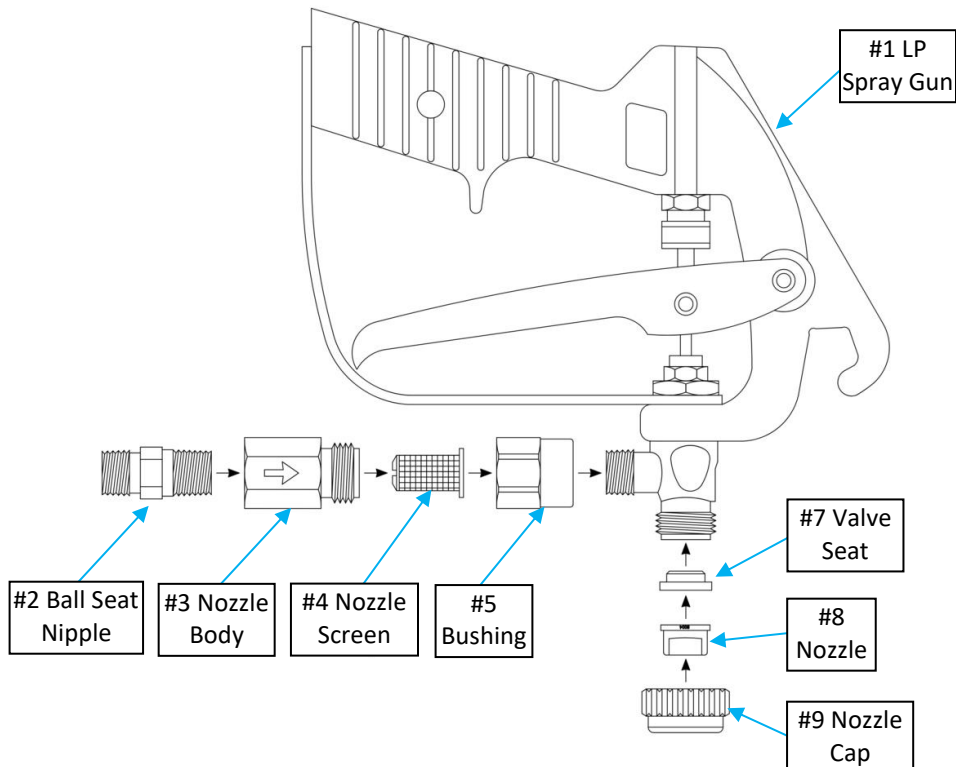

LineRider™ Electric UTV Mounted Line Striper

PARTS LIST

Item	Description	Part Number
#10	Chassis	10002350
#11	25 Gallon Paint Tank	10004005
#12	2.5 Gallon Purge Tank	10003198
#13	Tank Lid	10004647
#14	Battery Box	10002841
#15	Drain Hose Assembly	10002326
#16	Battery Wiring Harness	10002316
#17	Line Guide	10005189
#18	Line Guide Dangle	10005206
#19	Star Knob (2)	10000007
#20	Female Star Knob	10004480
#21	Paint Hose Assembly	10000695
#22	Spray Head	10005161
#23	Overspray Flap	10004967
#24	Rigid Caster	10000952
#25	(ON)/OFF/ON Rocker Switch	10004474
#26	Switch Wiring Harness	10002317

Item	Description	Part Number
#27	Purge Valve	10000233
#28	Return Hose Assembly	10002524
#29	Pump Outlet Hose Assembly	10002523
#30	8 Amp Automatic Battery Charger	10002844
#31	NoSpill Funnel	10003363
#32	Spray Pump	10002830
#33	Pump Feed Hose Assembly	10002321
#34	Inline Filter/Strainer	10000369
#35	3-Way Selector Valve	10005219
#36	Paint Feed Hose Assembly	10002320
#37	Purge Feed Hose Assembly	10002321
#38	Purge Drain Hose Assembly	10002319
#39	Tank Outlet Hose	10002318
#40	Tank Drain Valve	10004110
#41	Filter Replacement Screen (Not Shown)	10000100
#42	Fuse, ATO/ATC 20 Amp (Not Shown)	10002836

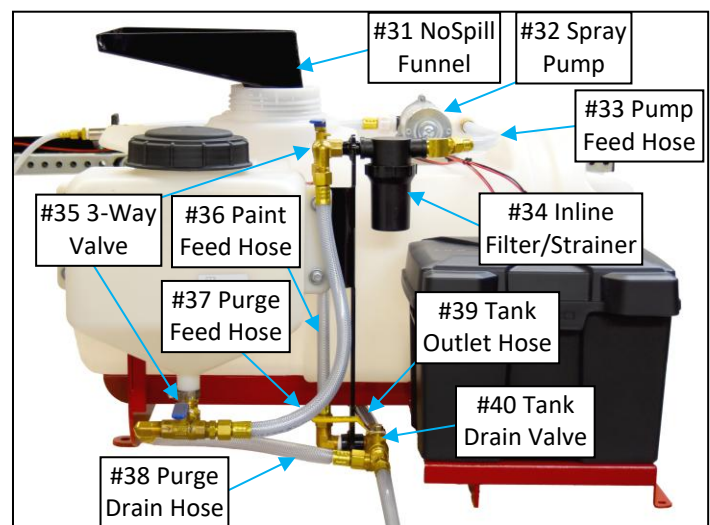
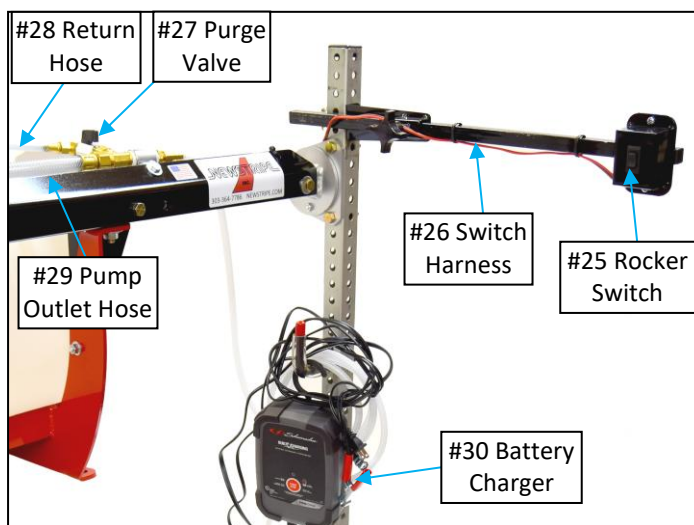
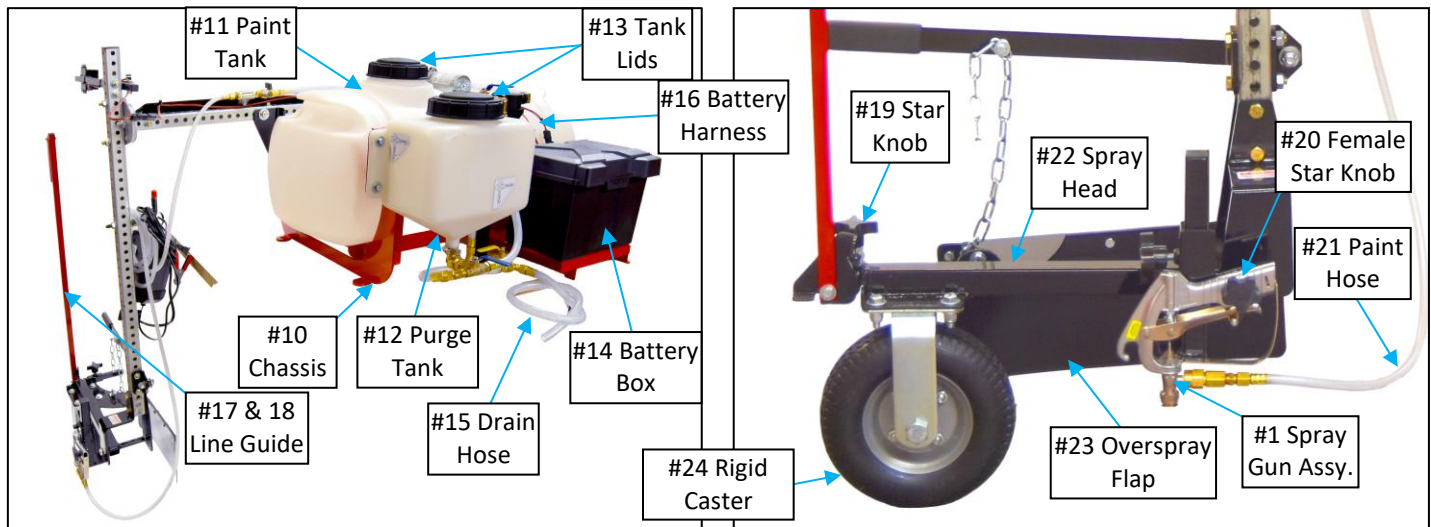

LineRider™ Electric UTV Mounted Line Striper

TROUBLESHOOTING GUIDE

PROBLEM	POSSIBLE CAUSE	REMEDY
The pump will not run.	The battery is not charged. The fuse is blown. The fuse has become disconnected.	Charge the battery. Change the fuse. Check the fuse holder connection and wires.
The pump will not prime.	The pump or hoses may be restricted.	Disconnect the supply and discharge hoses and clean them. Pour hot soapy water into the inlet of the pump and let it soak. Reconnect the hoses and restart the pump.
The pump still will not prime.	The spray system was not thoroughly cleaned after the previous use.	Pour more hot soapy water into the inlet of the pump. Jog the pump by operating the toggle switch briefly to get the soap into the pump. Let it soak for 15-30 minutes and then attach the hoses and then try pumping water. If the pump starts pumping water, let it circulate the water for 5-10 minutes before adding paint. The pump does not need to be rinsed of the soap, as it will mix easily with the paint. If the pump still will not prime, call Newstripe for assistance. Disassembly of the pump will void the warranty.
The paint is leaving the nozzle in a stream, and not a spray pattern.	The paint is too thick.	Thin the paint.
The spray stream is inconsistent.	The nozzle screen is obstructed. The filter/strainer screen is clogged or obstructed.	Remove the nozzle screen and clean or replace it. Remove the filter bowl, remove any clogs, clean the screen, and then replace the filter bowl.
The spray pattern is too narrow or is uneven.	The spray gun height is incorrect. The nozzle may be the wrong size, or misaligned. The paint viscosity may be too thick.	Adjust the spray gun height up or down to achieve the desired line width. See the Nozzle Assembly Guide. The nozzle slot must be at 90 degrees to the direction of travel. Thin the paint in accordance with the manufacturer's recommendations.
Paint drips from the nozzle after it is shut off.	The valve seat in the spray gun is dirty or worn. The nozzle screen is obstructed, not allowing the check ball to seat.	Disassemble the gun and clean or replace the valve seat. Remove the nozzle screen and clean or replace it.

Your machine is designed to be simple and safe to operate.

Please call Newstripe at 303-364-7786 if you have any questions during setup, painting, or cleaning.

LineRider™ Electric UTV Mounted Line Striper

10005241

36 Month Warranty

Newstripe, Inc. ("Newstripe") warrants to the original purchaser, for 36 (Thirty Six) Months after date of purchase, that the equipment* hereby sold shall be free of defects in materials and workmanship. This warranty does not extend to any damage or malfunction resulting in misuse, neglect, accident, improper operation, or normal wear and tear.

* Gasoline engines, compressors, low pressure pumps, and transaxles are furnished with their respective manufacturers' warranties only and are not covered by any warranty of Newstripe. High pressure pumps manufactured by Newstripe (excluding wear items like diaphragms and valves) are warranted for materials and workmanship for 12 Months after the date of purchase.

Damage incurred in shipment from Newstripe to the purchaser is the total responsibility of the shipping carrier. The purchaser is responsible for noting any damages on the Bill of Lading of the shipping carrier and Newstripe will work with the shipping carrier to resolve any damages incurred.

The Newstripe obligation under this warranty and any implied warranties is limited to replacement or repair of defective parts of its manufacture without charge for 36 (Thirty Six) Months from date of purchase. For service under this warranty, the purchaser shall obtain an approved Return Materials Authorization (RMA) from Newstripe and then ship the defective part or parts of the equipment, transportation prepaid by the purchaser, to Newstripe together with a written description of any claimed defect and proof of purchase date of the materials being returned. To review Newstripe's complete guidelines for warranty claims and returns, please visit our website at www.newstripe.com.

The responsibilities described above are the only responsibilities of Newstripe under this written warranty or any implied warranty and may be exercised only within 36 (Thirty Six) Months from the date of original purchase. In no event shall Newstripe be liable for incidental or consequential damages and no person had any authority to bind it to any representation or warranty. Newstripe is not responsible for work done, materials furnished, or repairs made by others without its specific written authorization.

This warranty shall be in lieu of any and all other warranties, expressed or implied, including any warranties of merchantability or fitness for a particular purpose, and there is no other representation or warranty of any kind with respect to the goods sold hereby except as set forth herein. It is expressly agreed that this warranty shall be limited to the adjustment, repair or replacement of parts and the labor and services required thereby. In no event, including any claim of negligence, shall Newstripe be liable for incidental or consequential damages.



Newstripe.com / 303-364-7786